

### Connecting your Laptop to TV



Picture 1

### Connecting your Laptop to TV

Step 1: Connect the DOC to your laptop using the USB-C connector as shown above. (Picture 1)

Step 2: Power ON the TV using the remote. (Wait 5 seconds to ensure standby light is off)

Step 3: Find the input source button on TV remote and select HDMI 3 as source

Step 4: You should be able to see your screen mirrored on TV

### Robotics Plus (Important Web Addresses)

Atlassian Home Page	<a href="https://roboticsplus.atlassian.net">roboticsplus.atlassian.net</a>
Office 365 login	<a href="https://www.portal.office.com">www.portal.office.com</a>
SharePoint	<a href="https://www.roboticsplusltd.sharepoint.com">www.roboticsplusltd.sharepoint.com</a>
Slack	<a href="https://www.roboticsplus.slack.com">www.roboticsplus.slack.com</a>

### Extending your laptop screen on TV

Step 1: On your Windows 10 laptop press Windows Key+P key together

Step 2: From the project Screen selection as shown below select "- Extend" (Picture 2)

Step 3: Your Windows 10 laptop screen will be extended to TV

### Extending your laptop screen on TV

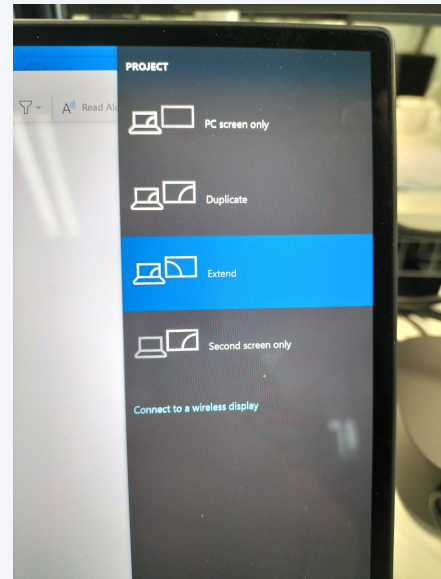

Picture 2

### Handy Keyboard shortcuts

Display and hide the desktop	Windows logo key + D
Open the Connect quick action	Windows logo key + K
Lock your PC or switch accounts	Windows logo key + L
Choose a presentation display mode	Windows logo key + P
Take a screenshot of part of your screen.	Windows logo key + Shift + S
Maximize the window	Windows logo key + Up arrow OR F11